



ROSEWOOD MAUSOLEUM
Ferncliff Cemetery, Hartsdale, NY



1. Original Architect Simulation



2. First Concept Simulation



3. Second Sketch Study

A protracted approval process led to Landplan providing prime consulting services for the site planning, civil engineering, landscape architecture, and construction administration. An existing drive was transformed into a tree-lined granite promenade a forecourt sculpture remains garden.

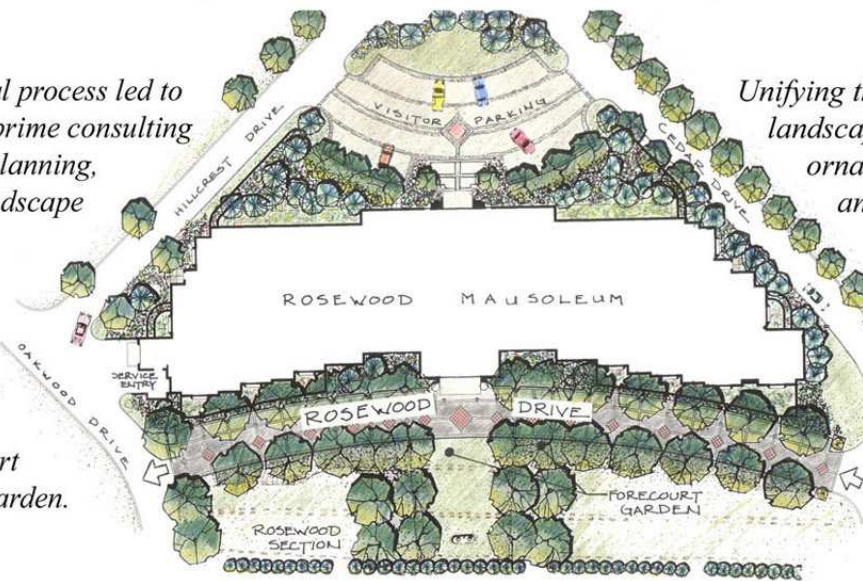

Unifying the promenade landscape is a combination ornamental ironwork, stone and granite softened by perennials selected for color fragrance and seasonal bloom. This sequence of illustrations document the evolution of design through construction.

6. The Constructed Design

5. Model of Design

4. Final Illustration

